

REVISIONS						
ZONE	LTR.	DESCRIPTION	ECN NO.	DATE	BY	APPR'D
	A	RELEASED FOR PRODUCTION	DR7633	10/15/06	DPZ	
	B	B1 WAS WIRE TIE	CR71215	8/21/07	DJC	DJC
2B	C	C1 REMOVED WIRE SLEEVE	DR16326 71450	19MAY08	SLK	DJC
3A	D	D1 UPDATE ASSEMBLY TO PUMP CAP/DOME COVER PLATE DESIGN	DR23287			
4C		D2 ADD WIRE HARNESS DETAIL	71893	28APR09	WDE	DJC
		D3 RV0000316 WAS RV0000316	72049			
		D4 TU215 WAS FM0001847 ON CHART DRAWING SA0039239				
3A	E	E1 REPLACED "HOT STAMP INFO" WITH "MARKING INFO"	73288	06DEC10	SLK	DJC

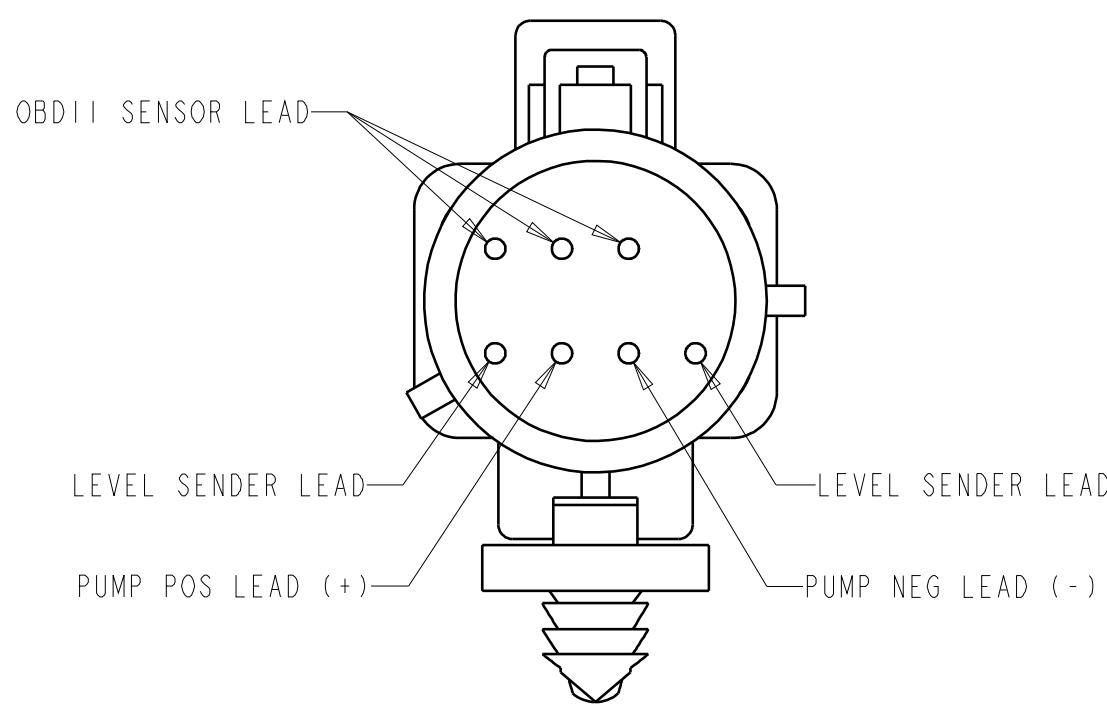

CONNECTOR
MODULE MAIN
PINOUT DETAIL
SCALE 2:1

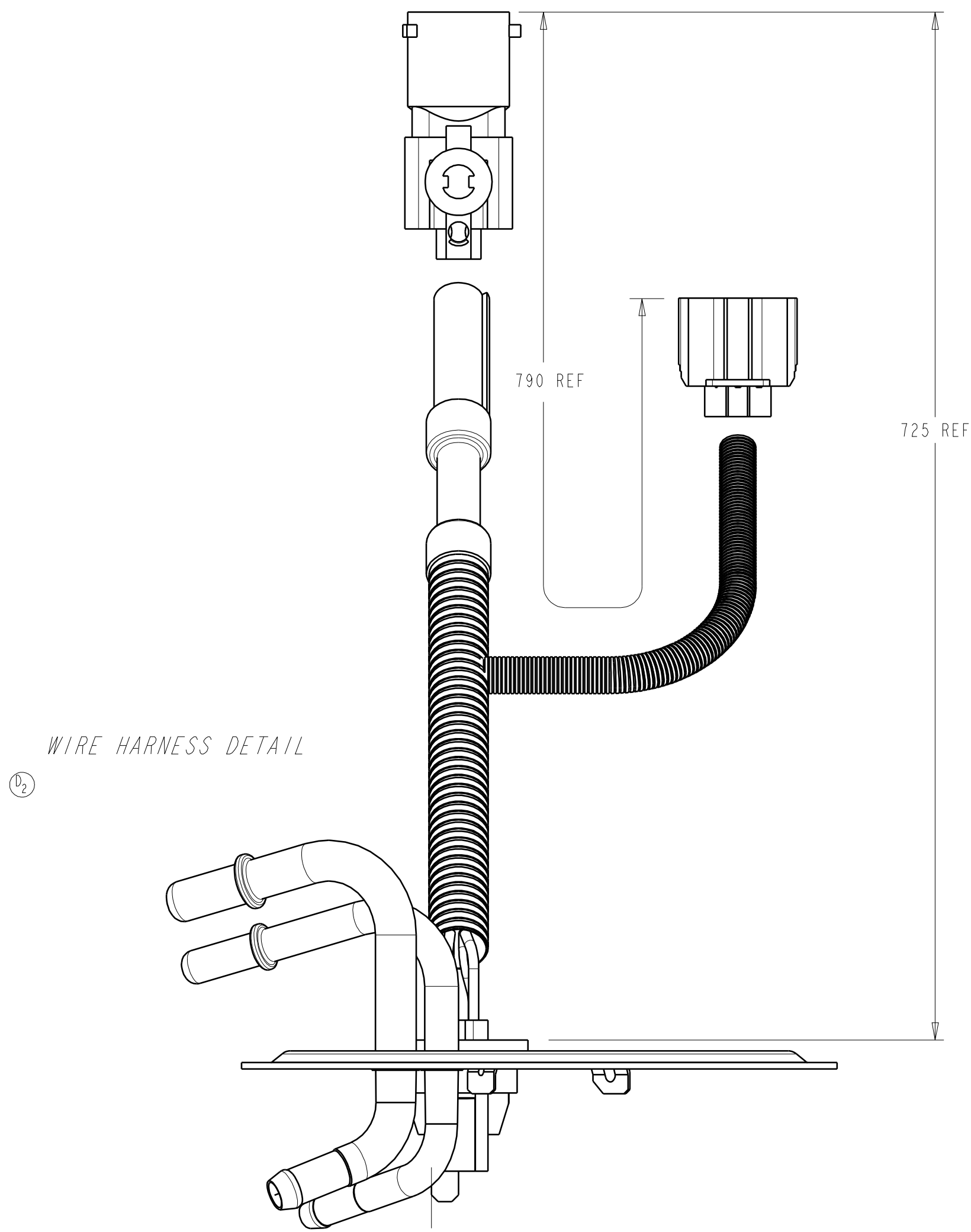

WIRE HARNESS DETAIL

1

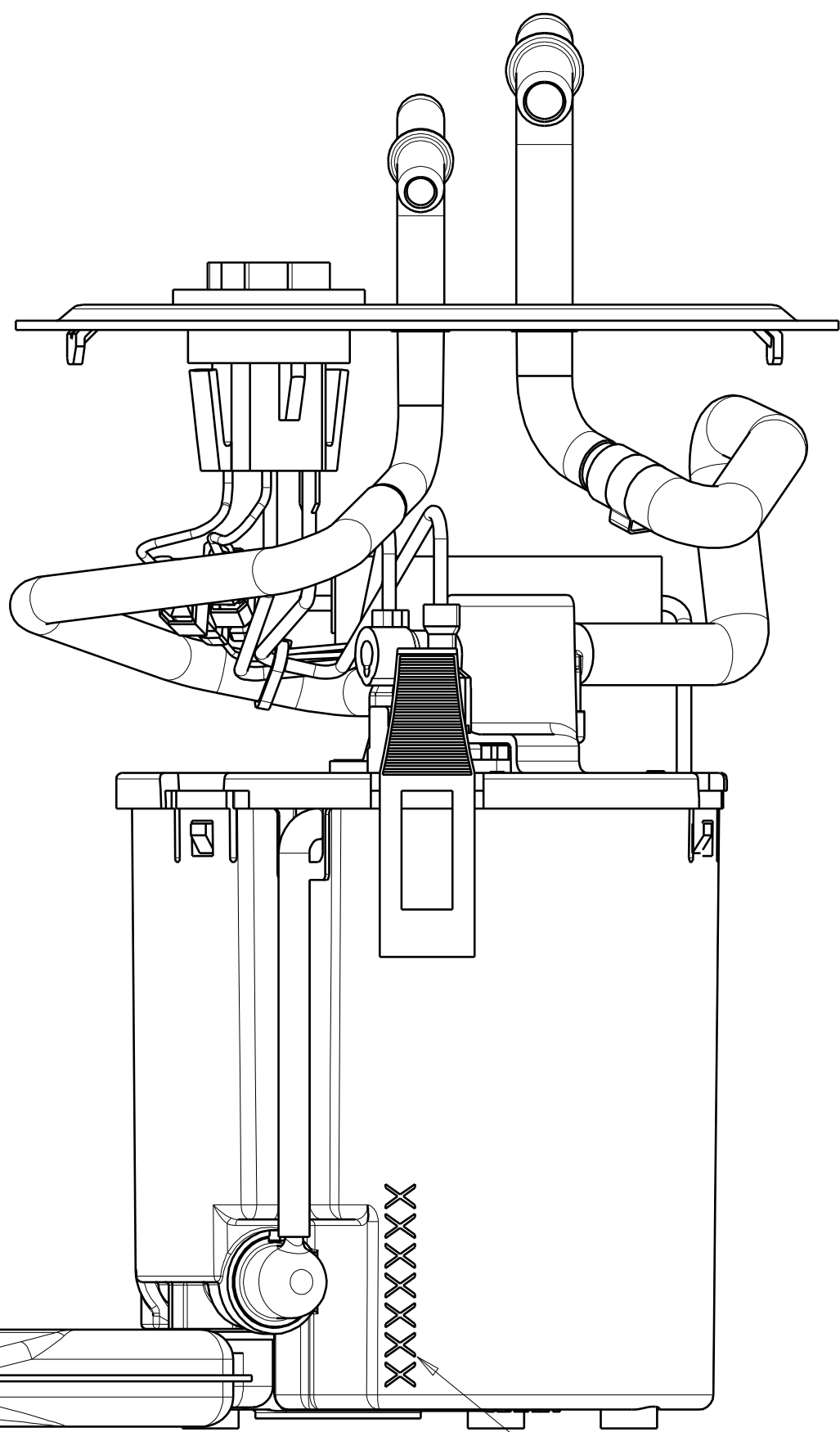

MARKING INFO
REFERENCE BILL OF MATERIALS

MAIN CONNECTOR PLUG

OBD11 SENSOR PLUG

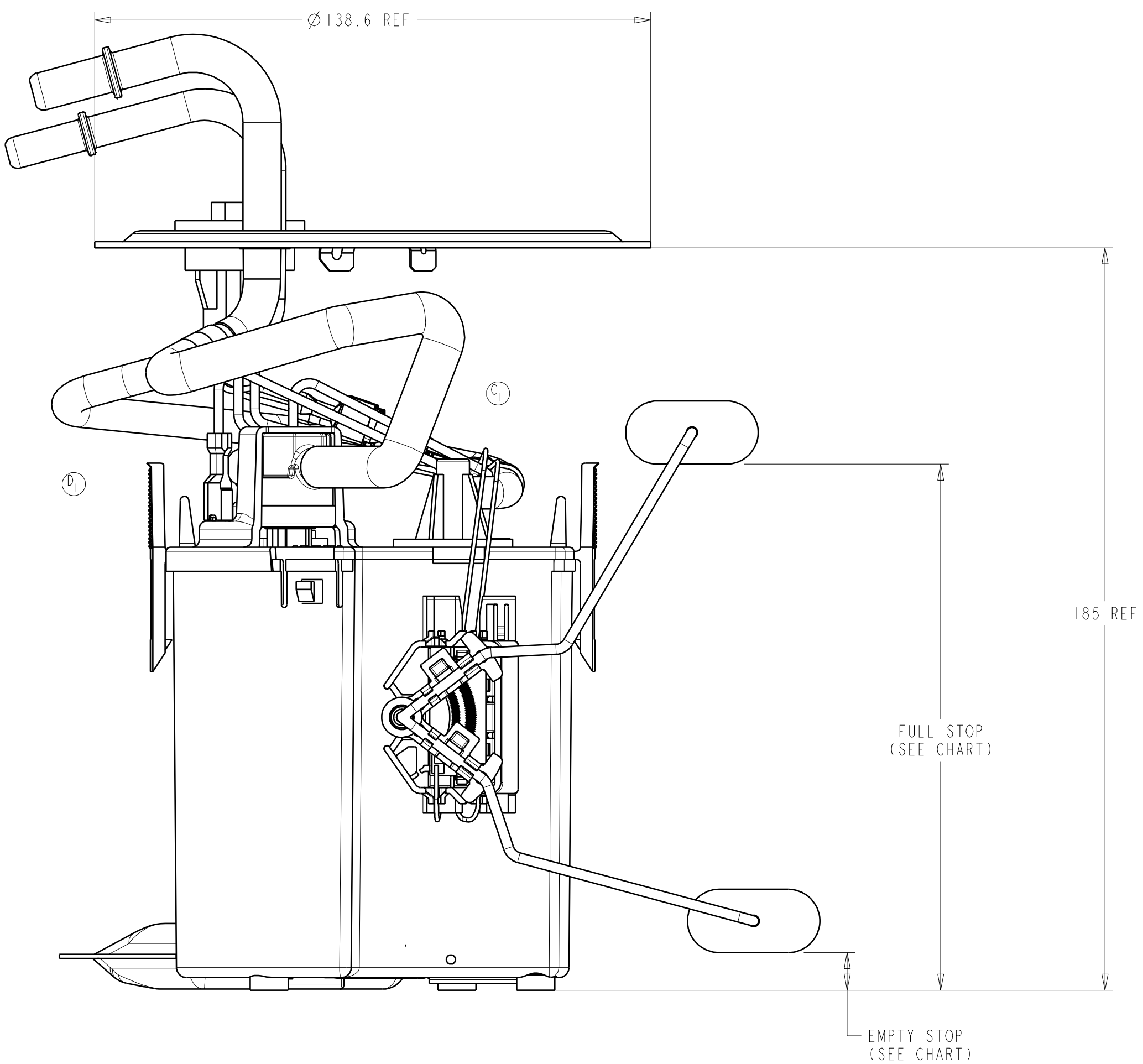
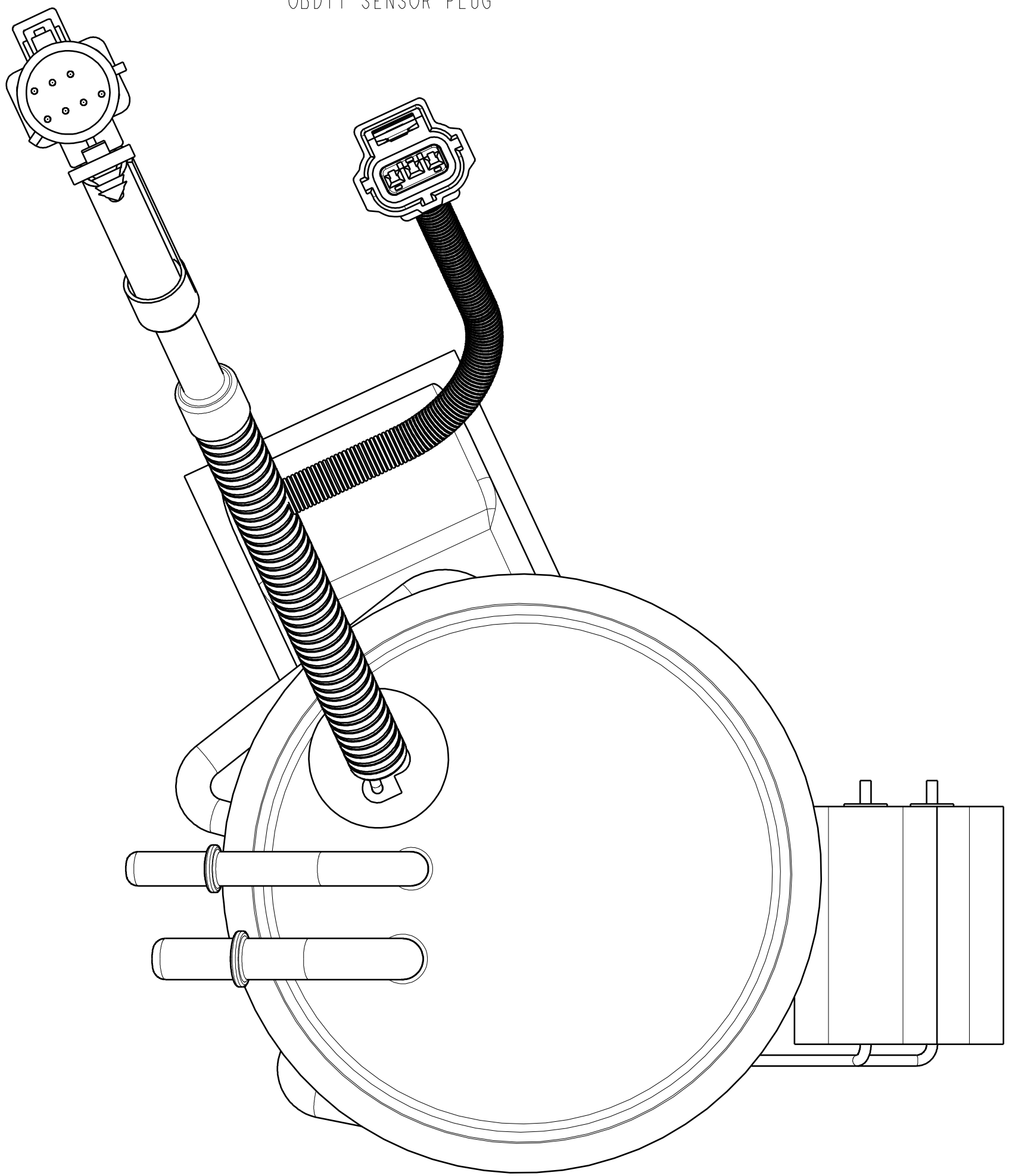

FLOAT POSITION	RESISTANCE (OHMS)
FULL STOP (131.7)	160.5±3.0
EMPTY STOP (110.0)	15±1

- NOTE:
- SPECIAL CUSTOMER PACKAGING REQUIREMENTS MAY CALL FOR THE ADDITION OF SPECIFIC LABELS NOT SHOWN ON THIS DRAWING.
 - SHOWN WIRE ROUTING MAY DIFFER FROM FINISHED PRODUCT.
 - SHOWN RESISTOR CARD AND PUMP TERMINATION MAY DIFFER FROM FINISHED PRODUCT.

INTERNAL USE ONLY DISTRIBUTION CODE		AF		REF: FM0001847		TOLERANCE UNLESS OTHERWISE SPECIFIED		MATERIAL		SCALE: 1:1 DATE: 3/20/06	
DO NOT SCALE PRINT		E		DIMENSIONS AND TOLERANCES PER ANSI/ASME Y14.5M - 1994		FINISH		CHAR BY: D. P. ZBORAY		APPRO'D BY:	
PRODUCTION		PRODUCTION		PRODUCTION		PRODUCTION		PRODUCTION		PRODUCTION	
PRO-E		PRO-E		PRO-E		PRO-E		PRO-E		PRO-E	
TITLE		FUEL MODULE OUTLINE		DRAWING NO. TU215		REV. E		AFTERMARKET DIVISION 630 COLUMBIA STREET CARO, MICHIGAN 48723			